

STEEL OIL TANK

Painted steel oil tank for hand pumps
lt. 13

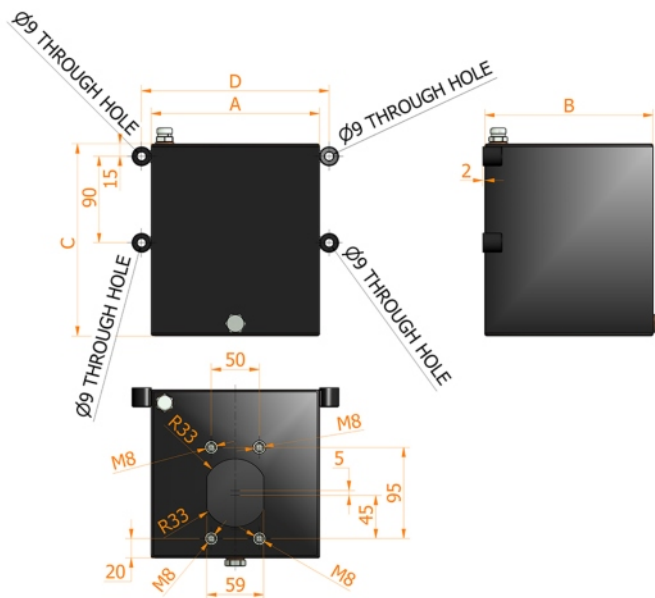

Specifications:

- Model S13 ac 175x175x485
- Suction pipe included
- Breather cap 1/4 G
- Release cap 1/4 G
- Standard colour black

CAPACITY liters	A mm	B mm	C mm	D mm	MASS KG	SUCTION PIPE	CODE
13	175	175	485	195	10,750	Ø10x425 mm	6500.0147